

LUXALON®

# XLnt Panels

Hunter Douglas Luxalon® XLnt Ceiling system combines the latest technology with efficient manufacturing techniques, high quality, extremely flat and extra large sized ceiling panels. The smooth and uniform effect obtained with the Luxalon® XLnt Ceiling system does justice to the vision of the designer as no other solution can.

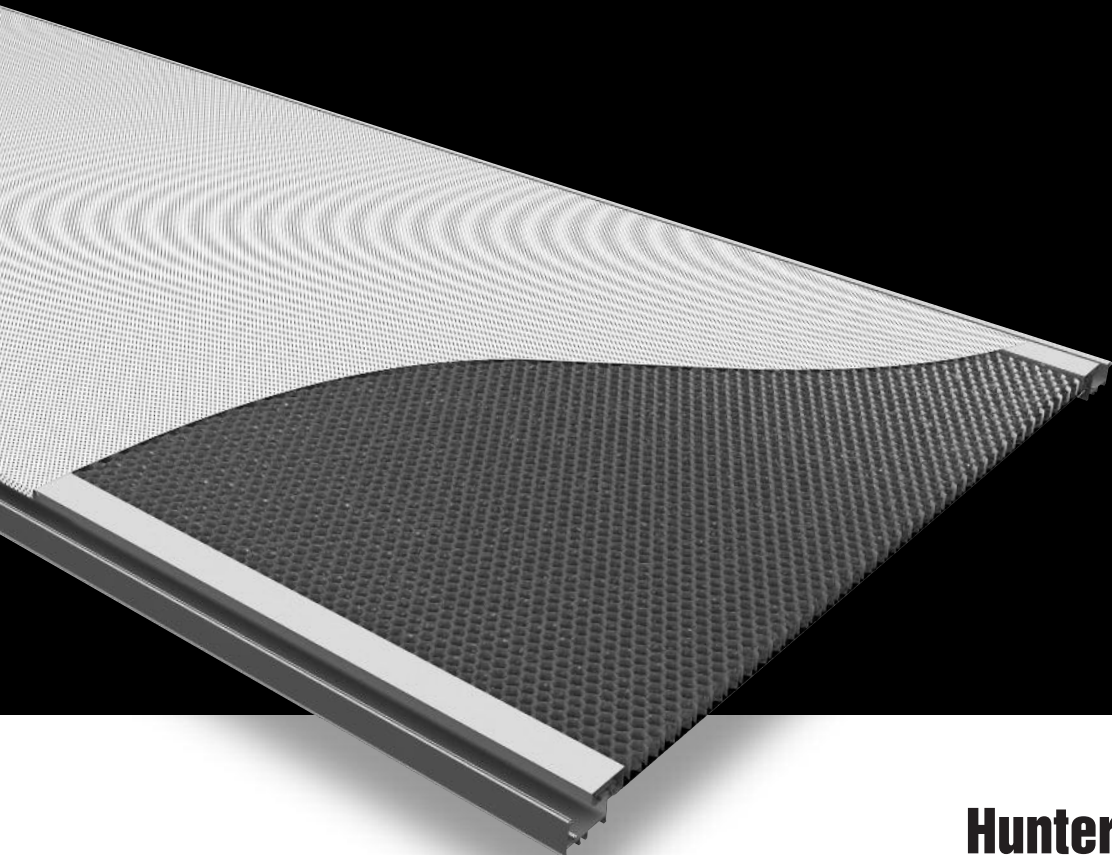

**HunterDouglas**

CEILINGS



# XLnt Panels

## Super-size your ceiling

### DESIGN FLEXIBILITY

The flatness, the size of the panels and the small joint results in a very clean, smooth ceiling design. Especially in bigger sized panels, the ceiling has a monolithic high-end appearance.

Luxalon® XLnt Ceiling systems are utilised for high quality ceiling designs for which the following are of primary importance:

- Superior flatness
- Smooth appearance
- Easy installation
- Swing down operation
- Big panel size
- Narrow joints
- High panel quality
- Fire retardent

The smooth and uniform effect obtained with the Luxalon® XLnt Ceiling system does justice to the vision of the designer as no other solution can. Luxalon® XLnt Ceilings have been used by leading architects in prestigious projects all over the world.

### DURABILITY

The design of the panel has been derived from techniques proven in the aircraft industry. As a result, the product has an intrinsic high quality and durability. The Luxalon® XLnt panels are produced in a ISO 9001 / 14001 certified organisation and we do of course produce our products in accordance with the TAIM standard. The product is also in compliance with the European suspended ceiling standard EN 13964.

### EASY PLENUM ACCESS

The swing down system enables simple access to the plenum in an installed ceiling.



For over 50 years Luxalon® has been offering a wide product program of metal ceilings and specialties such as: Wide Panel, Cell, Tile, Linear and Wooden Ceilings.

With the new Luxalon® XLnt Ceiling system, Hunter Douglas has combined the latest technology with efficient manufacturing techniques in order to serve the architects demand for high quality, extremely flat and extra large sized ceiling systems.

#### **FIRE BEHAVIOUR**

Safety is an essential aspect of the XLnt ceiling system. Luxalon® has designed the system for maximum safety whereby the ceiling conforms to the European fire classification.

The product has been classified as follows according to EN 13501-1:

Reaction to fire : Euroclass B

Smoke production: s2

Flaming droplets : d0

## **CONTENT**

Page

**XLnt Panel**

2

**Technical Data**

4

## **Innovative Products Make Innovative Projects**



**HunterDouglas**

# XLnt Panels

## PANELS

The XLnt Ceiling panel principle:

- All Luxalon® XLnt panels are based on composite technology that originate from the aircraft industry.
- Pre-coated aluminium skins are roll-formed and integrated with honeycomb reinforcement and aluminium fixing extrusions. With this state of the art technique, extremely flat panels are being produced.

## EXTRA LARGE SIZES

The result of the composite construction is the possibility of making extra large panels that remain flat, light and need few supporting points. The Luxalon® construction method enables the designer to almost ignore the span of the material giving him an enormous amount of freedom in creating his designs.

## HOOK ON SYSTEM

The panel is fixed to the support system by means of a Hook-on System. Each panel can be individually dismantled, to allow easy access for equipment maintenance and repairs and panel replacement.

## INTEGRATED FIXED NARROW JOINT

The panels have been designed with an integrated fixed narrow joint of 12.5 mm along 4 sides of the panel.

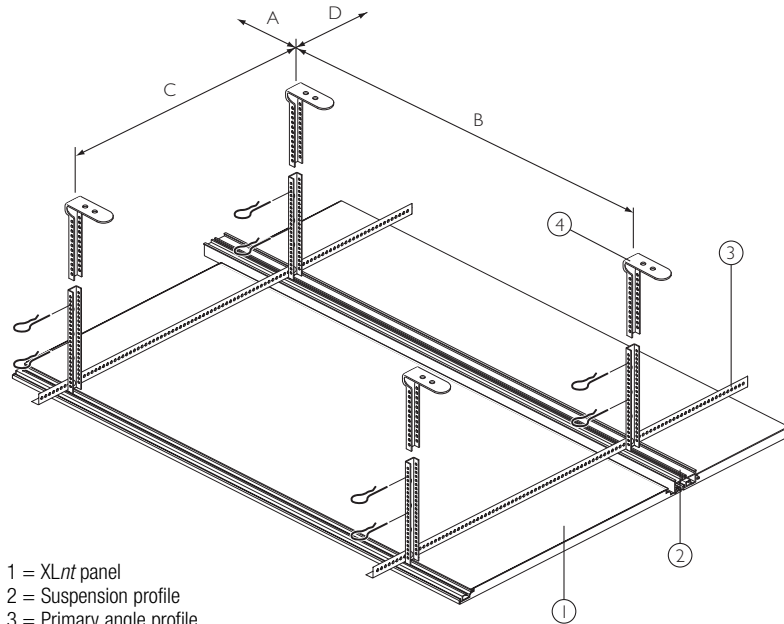

- 1 = XLnt panel
- 2 = Suspension profile
- 3 = Primary angle profile
- 4 = Nonius hanger with locking clips

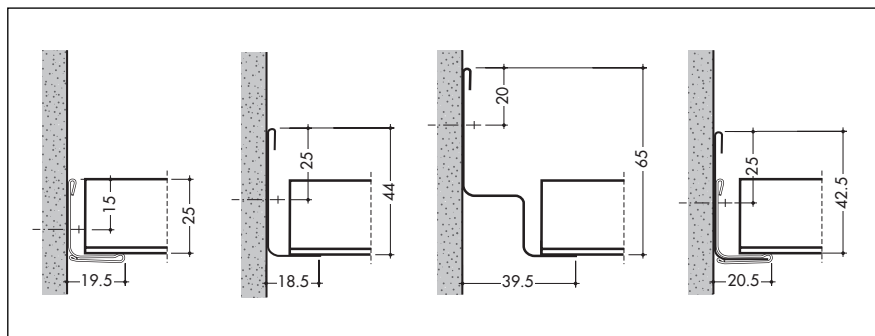
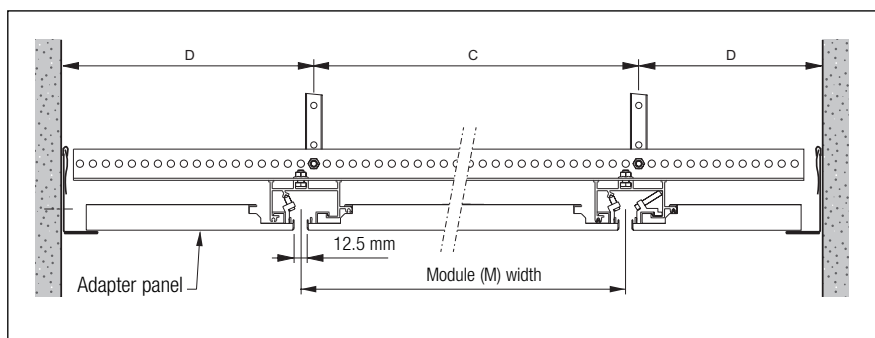

## MAXIMUM SPANS

Panel type	Carrier span (mm)		Panel span (mm)	
	A	B	C	D
XLnt	150	1250	M	≥ 1/2 M

## DIMENSIONS & WEIGHTS

Indicated weight including subconstruction

Panel	min	max	plain panel	perf panel
width (mm)	600	1250		
length (mm)	1000	2500		
M = 600 x 1000 mm			13.3 kg/m <sup>2</sup>	12.7 kg/m <sup>2</sup>
M = 1250 x 2500 mm			8.5 kg/m <sup>2</sup>	6.7 kg/m <sup>2</sup>

## MATERIAL REQUIREMENT PER M<sup>2</sup>

Based on panel dimension 1.0 x 2.5 m

	Unit	Quantity
panel	lm	1.00
suspension profile	lm	1.00
suspension profile splice	pc	0.20
primary angle profile	lm	0.80
primary angle splice	pc	0.16
suspension	pc	0.80

### SWING DOWN SYSTEM

Unscrewing\* the bolt of the locking block (5) in the standard panel sets the panel edge free. A slight pulling motion makes that the panel can swing-down on the opposite edge. If necessary the panel can then also be demounted completely. Adapter panels can be demounted by unscrewing\* the adapter panel fixing block (6).

\*Use a 2.5 mm hexagon screwdriver (allen key)

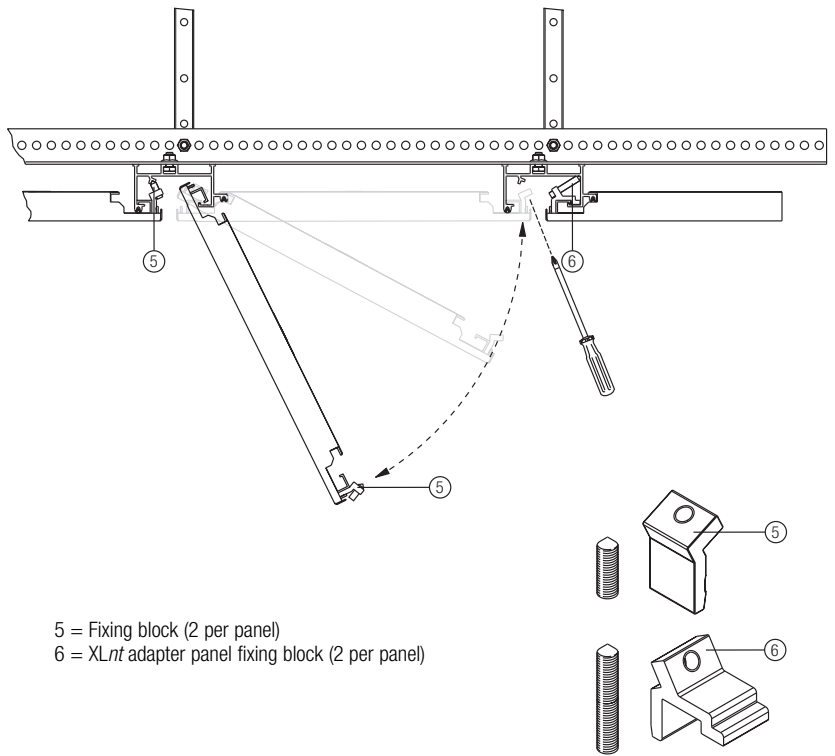

### PLENUM ACCESSIBILITY

The swing down system allows easy access to the plenum. If necessary, each panel is demountable and replaceable by hand.

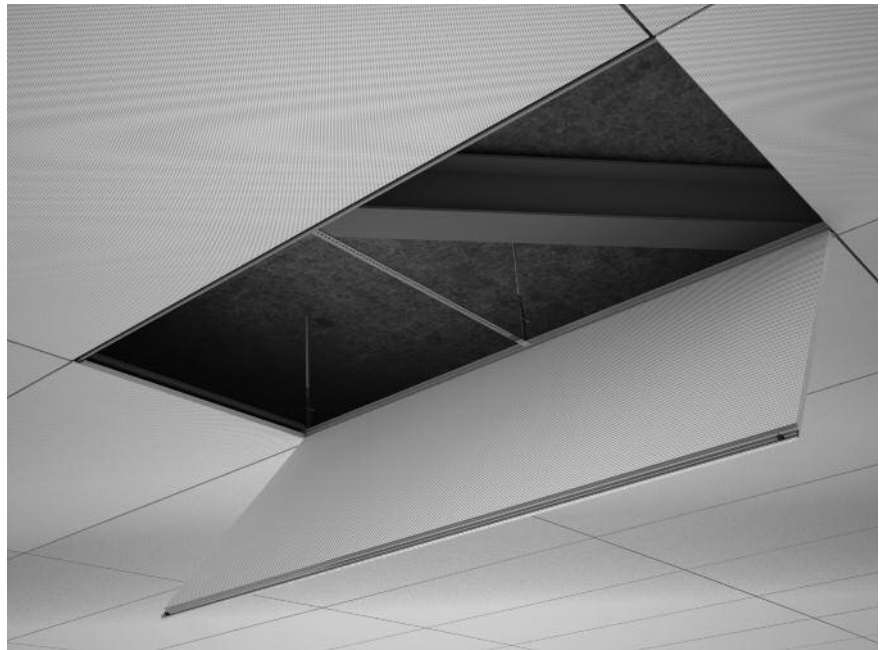



# Technical Data

## COLOURS, FINISHES AND SPECIALTIES

The standard finish for the panel is a stove enamelled polyester coating, which guarantees optimum consistency of colours and perfect adherence to the substrate. Standard colour is 0280. All other colours can be produced on request.

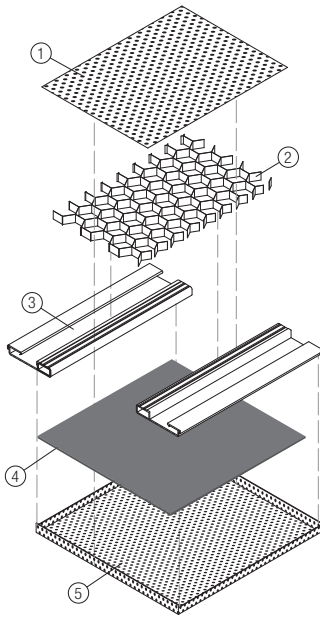

## COMPOSITE CONSTRUCTION

1. Pre-coated inside skin
2. Aluminium honeycomb
3. Aluminium side extrusion
4. Non-woven acoustic tissue
5. Pre-coated and roll-formed outside skin

## LUXALON® XLnt CEILING

<b>Aluminium skins</b>	Pre coated coil
• Alloy	EN AW3005, H44
• Thickness	Front skin: 0.95 mm Back skin: 0.5 mm
• Perforation	Front skin Ø 1.5 T3, 22% Back skin Ø 3.0 T5, 32%
<b>Coatings</b>	Front side Polyester Back side Polyester or primer
<b>Colour</b>	Standard 0280 (equals RAL 9010), 10-15% gloss. Any other colour to match RAL, NCS or other standard on request
<b>Aluminium Honeycomb Core</b>	Pre-treated corrosion-resistant aluminum honeycomb
• Alloy	EN AW3003
• Foil thickness	0.076 mm
• Cell size	19 mm
<b>Suspension profile</b>	EN AW6063 T5
<b>Adhesive</b>	1 part temperature cured Polyurethane glue
<b>Reaction to fire</b>	Euroclass B (EN 13501-1: 2002)
<b>Smoke production</b>	S2
<b>Flaming droplets</b>	d0
<b>Weight</b>	6.7 ~ 13.3 kg/m <sup>2</sup>
<b>Panel size</b>	(in mm)
Module width	600 - 625 - 750 - 900 - 1000 - 1200 - 1250
Module length	1000 - 2500
Thickness	25

## XLnt

XLnt panels with Ø 1.5 mm front skin and Ø 3 mm back skin perforation. The reverse side of the outside skin is provided with black non-woven tissue glued over the whole perforated area. Plenum depth is 200 mm.

Tested by Peutz; test report no: A 2428-2

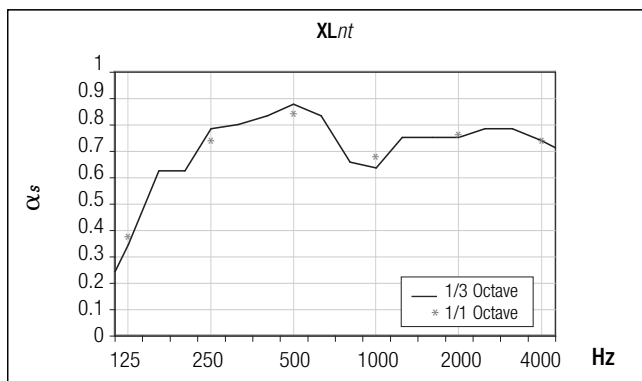

Freq. Hz.	125	250	500	1000	2000	4000	αw	NRC
1/3 oct.	0.17	0.63	0.83	0.66	0.75	0.78	0.75	0.75
1/3 oct.	0.36	0.78	0.87	0.64	0.75	0.74	0.75	0.75
1/3 oct.	0.63	0.80	0.83	0.75	0.78	0.69	0.75	0.75
1/1 oct.	0.39	0.74	0.84	0.68	0.76	0.74	0.75	0.75

## HUNTER DOUGLAS ARCHITECTURAL PRODUCTS

In the last 50 years, we've been fortunate enough to help turn countless innovative sketches into innovative buildings. With major operation centres in Europe, North America, Latin America, Asia and Australia, we've contributed to thousands of high-profile projects, from retail and commercial facilities to major transit centres and government buildings.



## ARCHITECTURAL SERVICES



We support our business partners with a wide range of technical consulting and support services for architects, developers and installers. We assist architects and developers with

recommendations regarding materials, shapes and dimensions, colours and finishes. We also help creating design proposals, visualisations and mounting drawings. Our services to installers range from providing detailed installation drawings and instructions to training installers and advising on the building site.

Architects, designers, investors and contractors from around the world have taken advantage of Hunter Douglas' unmatched product development, service and support. Chances are, you've seen more of Hunter Douglas than you think.

Not only are the world's architects and designers our partners, they're our inspiration. They continue to raise the bar for excellence. We create products that help bring their visions to life: Window Coverings, Ceilings, Sun Control Systems and Façades.

## Innovative Products Make Innovative Projects



Promoting sustainable forest management  
[www.pefc.org](http://www.pefc.org)



All aluminium products are 100% recyclable at the end of their lifecycle.



## Learn More

- Contact our Sales office
- [www.hunterdouglascontract.com](http://www.hunterdouglascontract.com)

Wide Panel

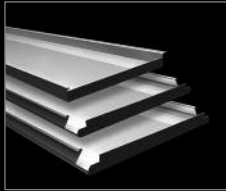

Linear

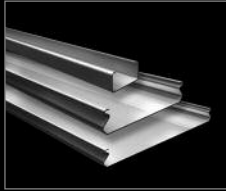

Screen



Tiles  
XLnt panel

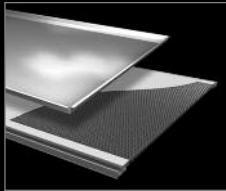

Cell  
Stretch metal

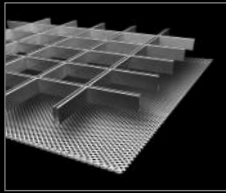

Curved

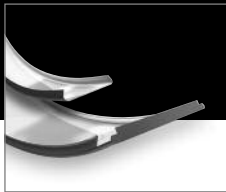

Exterior

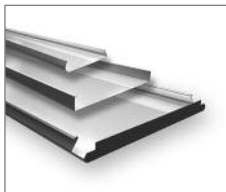

- Belgium
- Bulgaria
- Croatia / Slovenia
- Czechia
- Denmark
- France
- Germany
- Greece
- Hungary
- Italy
- The Netherlands
- Norway
- Poland
- Portugal
- Romania
- Russia
- Serbia
- Slovakia
- Spain
- Sweden
- Switzerland
- Turkey
- United Kingdom
- Africa
- Middle East
- Asia
- Australia
- Latin America
- North America

**HUNTER DOUGLAS EUROPE B.V.**  
 2, Piekstraat  
 P.O. Box 5072 - 3008 AB Rotterdam  
 The Netherlands  
 Tel. +31 (0)10 - 486 99 11  
 Fax +31 (0)10 - 484 79 10  
[www.hunterdouglascontract.com](http://www.hunterdouglascontract.com)

# HunterDouglas