

# Veneered Wood Linear Panels





# Veneered Wood Linear Panels

Natural design and acoustics

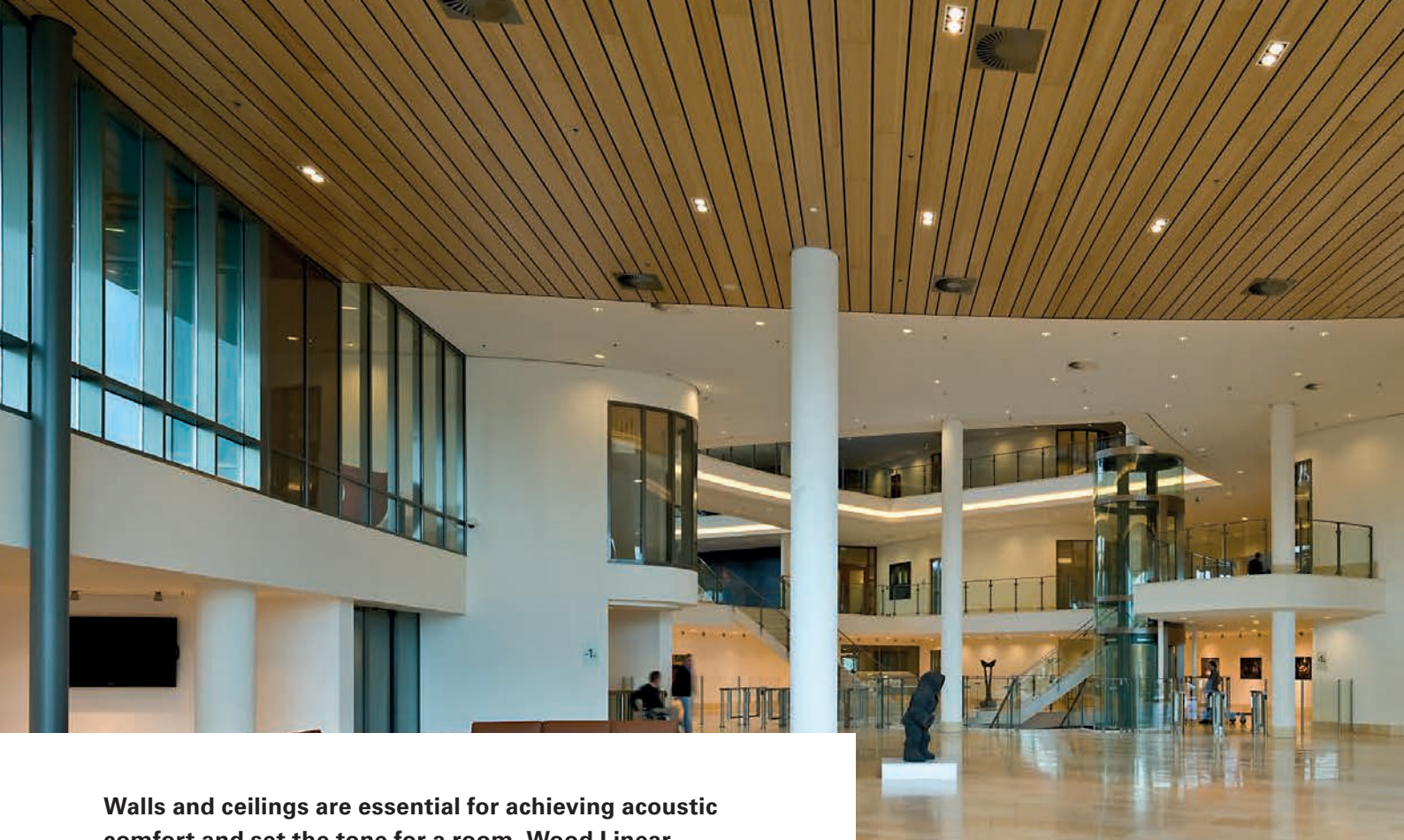

**Walls and ceilings are essential for achieving acoustic comfort and set the tone for a room. Wood Linear Panels meet these requirements. Various panel widths and thicknesses can be combined in a single system, resulting in a dynamic wall or ceiling solution.**

The core of the panel consists of MDF engineered solid wood (ESW) with a decorative top layer of finish of either a high quality real wood veneer, melamine, cork or a spray applied paint finish to any RAL colour. The dimensional stability of ESW ensures that there is plenty of freedom in the widths and thicknesses of the slats.

Special fixing clips make installation in a T-24 grid extremely quick and straightforward. It is also possible to remove panels individually and gain access to the plenum.







## Great design freedom

Wood linear panels provide architects with design freedom while maintaining the acoustics:

- Top layer: a choice of over 40 veneer types/ HPL-melamine decor/cork.
- Various panel and joint widths, to be combined in a single system.
- Finish: colour stain/matt or gloss paint/RAL or NCS colour
- Available as a ceiling or wall solution.

## Dimensions

Straightforward installation coupled with the ability to remove panels individually together with their acoustic performance make Wood Linear Panels the ideal wall and/or ceiling solution.

The minimum panel width is 65 mm and the maximum is 290 mm. The ideal length of the panels depends on the scheme, with panels available in lengths up to 3000 mm.

The intermediate space of the slats is determined by metal clips which are used for installation. This makes it possible to create intermediate spaces of 1 to 30 mm. The intermediate spaces can be filled with an acoustic black strip or veneer strip.

There is also the possibility of supplying the panels in completely removable cassettes.



Cover : Driestar, Leiden,  
The Netherlands  
Product : Ceiling - Linear cassette -  
Essen (white wash)  
Wall - Linear elements  
Architect : Roosros architecten

Project : KPMG, Amstelveen,  
The Netherlands  
Product : Linear Bamboo khaki  
Architect : Marcel van der Schalk



Promoting sustainable  
forest management  
[www.pefc.org](http://www.pefc.org)



## Specifications

**Base material** : 16 mm fire-retardant MDF, (B-s1,d0 - EN 13501-1), moisture-resistant MDF also available.

**Top layer** : high-grade veneer/HPL-melamine decor/cork.

**Panel dimensions** : 65-290 x 3000 mm (max.).

**Cassette dimensions** : 600 x 600 mm  
1200 x 600 mm.

*Other sizes available on request*

**Joint widths** : 1 / 5 / 10 / 15 / 20 / 30 mm.

**Acoustic cloth** : black.

**Installation system** : by means of metal rotatable clamps on a T-24 grid or direct attachment to frame with metal screw clamps.

**System** : ceiling or wall.

# Acoustics

A fire-retardant, sound-permeable connecting strip or cloth is fitted between the panels to ensure the absorption of sound energy. In addition to the acoustics, these elements also ensure that the void is concealed and prevent dust falling through from above.

Sound energy is absorbed through the open area between the slats, thereby ensuring acoustic comfort.

It is necessary to have sufficient open space for sound absorption. The open space can be increased by:

- adaptation of the width of the panel and the intermediate gap.
- creation of additional open area via round perforations in the panel.



Above : Zinn, Groningen, The Netherlands  
Product : Linear cassette - Essen, clear lacquer.  
Architect: Team 4 architecten

The table shows the test results for wood linear panels:

- 17 mm-thick panel, 90 mm wide, 20 mm joint.
- Soundtex 0.2 mm.
- Rockwool 20 mm.
- Test method: ISO 354:1985/Amd.1:1997 (EN 20354:1993), ISO 11654:1997, ASTM-C423-90a.

$\alpha_w$  0.50  
NRC 0.70

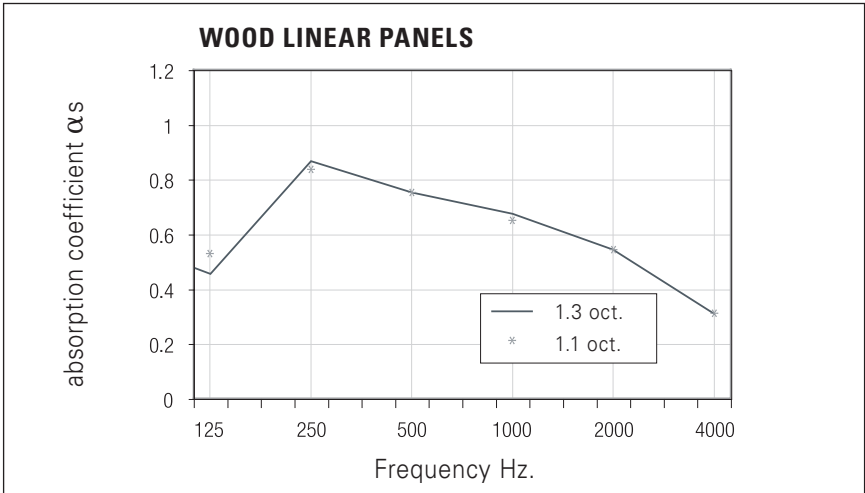

FREQUENCY (HZ)	125	250	500	1000	2000	4000
1/3 octave	0.49	0.81	0.79	0.69	0.52	0.39
	0.46	0.85	0.76	0.67	0.47	0.33
	0.76	0.84	0.73	0.58	0.43	0.28
1/1 octave	0.57	0.83	0.76	0.65	0.47	0.33



# System overview

The Veneered Wood Linear panels are suitable for ceiling and wall application and can be supplied in three models.

## LINEAR SINGLE

- Individual panels for wall and ceiling applications
- Installation with metal screw clamps on a wood frame or installation with rotating clamps on metal omega profiles or a T-24 grid.
- Inspection openings provide access to the area behind the wall/above the ceiling.
- Special rotatable clamps allow the panels to be removed individually when used in combination with T-24 profiles.
- The acoustic connecting strip is fitted following installation of the panels.
- Various panel widths and thicknesses are available.

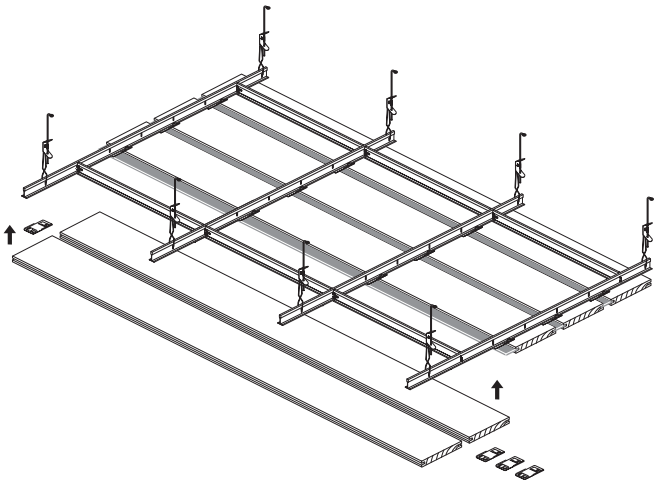

## LINEAR CASSETTES FOR CEILING APPLICATIONS

- Ready-to-use cassettes fitted in a system ceiling from below.
- Installation in a system ceiling consisting of a T-24 grid.
- Each cassette can be individually removed.
- The open area with acoustic cloth ensures good acoustics.
- Various panel widths and thicknesses are available.
- Dimensions: 600 x 600 mm  
1200 x 600 mm  
1500 x 300 mm.

*Other sizes available on request*

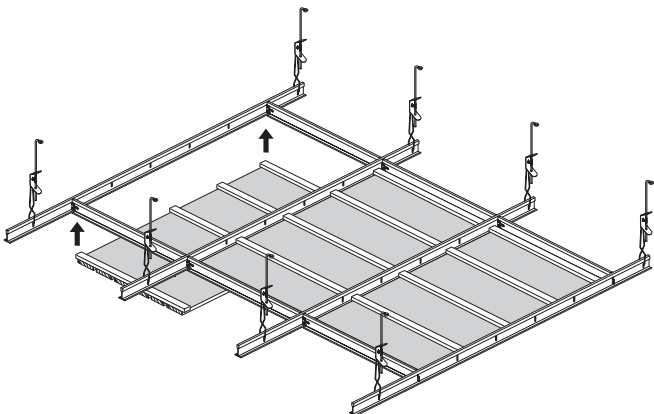

## LINEAR ELEMENTS FOR WALL APPLICATIONS

- Combination of panels where a connecting slat and acoustic cloth are fitted ex works to the rear with glue and rivets for direct wall fixing.
- The ready-to-use elements with a width of approx. 600 mm are screwed onto a wood or metal frame.
- The screw method allows each element to be removed individually.
- Particularly suitable for schools and sports halls.
- Combination of various panel and width thicknesses possible.
- Dimensions: 600 x 1500 mm.

*Other sizes available on request*

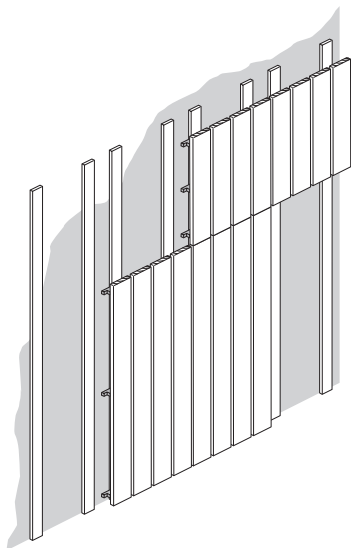

Ceilings



Sun Louvres



Façades



Belgium  
Bulgaria  
Croatia / Slovenia  
Czech Republic  
Denmark  
France  
Germany  
Greece  
Hungary  
Italy  
The Netherlands  
Norway  
Poland  
Portugal  
Romania  
Russia  
Serbia  
Slovakia  
Spain  
Sweden  
Switzerland  
Turkey  
United Kingdom  
Africa  
Middle East  
  
Asia  
Australia  
Latin America  
North America

**Hunter Douglas Architectural**

Piekstraat 2  
P.O. Box 5072 - 3008 AB Rotterdam  
The Netherlands  
Tel. +31 (0)10 - 486 99 11  
Fax +31 (0)10 - 484 79 10  
[www.hunterdouglasarchitectural.eu](http://www.hunterdouglasarchitectural.eu)